

Battery Ready Motor Kit



*Battery not included

Model 206K

OVERVIEW

Increase cut quality and productivity with Sawyer's Battery Ready Motor Kit. This kit converts a manual band crawler into an electric motor drive that is AC or battery powered - using a 20 volt DeWalt style battery. This is a simple upgrade that includes a mounting bracket and connector to connect to the crawler.

FEATURES AND BENEFITS

- Industrial grade, brushless motor for durability and long life
- Battery-powered, using a DeWalt style 20v battery (not included)
- Intelligent speed control with a range that allows for flame or plasma cutting
- Extension cords and plugs are water, arctic, and flame resistant
- Durable cast aluminum motor mount increases rigidity
- High visibility yellow polyimide control box with integrated handle
- Shielded magnet included on the control box for attachment to pipe during use

MOTOR KIT INCLUDES

- Brushless Motor
- Control Box
- Extension Cord
- Mounting Bracket
- AC Adapter

ESTIMATED SHIPPING WEIGHT

Model No.	Description	Weight
206K-110	110v Motorized Kit for Band Crawler - Battery Ready	10 lbs. 4.5 kg.
206K-220	220v Motorized Kit for Band Crawler - Battery Ready	10 lbs. 4.5 kg.

Follow us on social media and watch product videos on our YouTube channel **Sawyer Mfg**

918-834-2550



sawyer^{mfg}.com

Motorized Crawler Parts List

Battery Ready Motor Kit

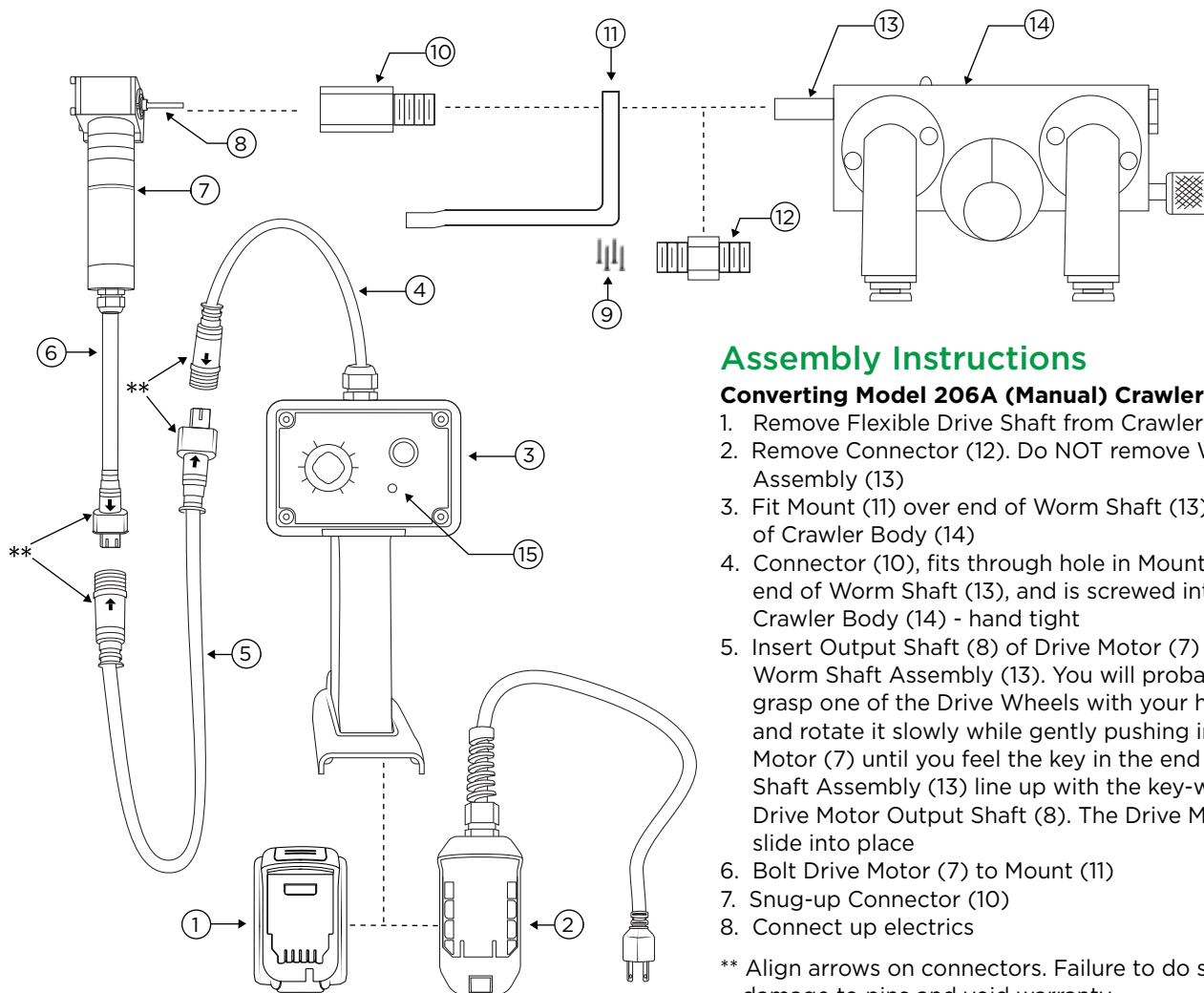

Assembly Instructions

Converting Model 206A (Manual) Crawler to Electric

1. Remove Flexible Drive Shaft from Crawler
2. Remove Connector (12). Do NOT remove Worm Shaft Assembly (13)
3. Fit Mount (11) over end of Worm Shaft (13), up to front of Crawler Body (14)
4. Connector (10), fits through hole in Mount (11), and over end of Worm Shaft (13), and is screwed into front end of Crawler Body (14) - hand tight
5. Insert Output Shaft (8) of Drive Motor (7) into end of Worm Shaft Assembly (13). You will probably have to grasp one of the Drive Wheels with your hand or pliers and rotate it slowly while gently pushing in on the Drive Motor (7) until you feel the key in the end of the Worm Shaft Assembly (13) line up with the key-way in the Drive Motor Output Shaft (8). The Drive Motor should slide into place
6. Bolt Drive Motor (7) to Mount (11)
7. Snug-up Connector (10)
8. Connect up electrics

** Align arrows on connectors. Failure to do so can cause damage to pins and void warranty

LED Light Colors:

Blue - When the knob is at zero and in forward or reverse - Shows Power is on

Green - Bright for first 5 seconds and then dims when above 0 speed on the knob

Red - Speed control has sensed caution so has stopped the unit. Make sure all items are clear for restart.

Switch needs to be set back to the middle to restart when ready

No.	Part Name	Part No.
1	Dewalt Style 20V Battery (not included)	525-76
2	AC Adapter for Cordless Yellow Box	525-71
3	Cordless Yellow Box Controller w/ Electronics	4TX
4	Yellow Box Cable with Plug	525-74
5	Connector Cable - 15 Foot	525-72
6	Brushless Motor Cable with Plug	525-75
7	Sawyer Brushless Motor	525-70
8	Output Shaft For Brushless Motor	29EJ
9	Screw for Motor Mount (Qty. 4 Req.)	515-35

No.	Part Name	Part No.
10	Connector for Motorizing Kit	114J-2
11	Transmission Motor Mount	114S
12	Connector for Flexible Drive Shaft	93B-1
13	Worm Shaft Assembly	4DA
14	Beveling Crawler Body	206A
15	LED Light	